

WOODWORKS® Linear

Solid Wood Panels

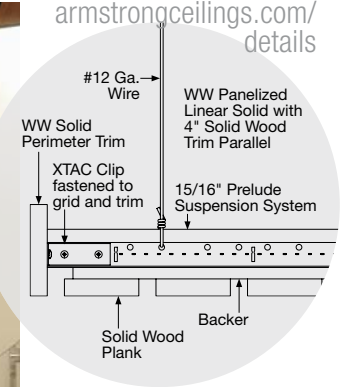

CAD/Revit® drawings at:
armstrongceilings.com/
details



See more photos at:
armstrongceilings.com/photogallery
SEARCH: woodworks linear

WoodWorks® Linear Solid Wood panels in Grille Dark Cherry on Prelude® XL® 15/16" suspension system (Pgs. 279-280)

Traditional or easy-to-install panels offer multiple ways to achieve a linear look.

ADDITIONAL ATTRIBUTES

Solid Wood Panels

- new** • Two plank widths – nominal 3" and nominal 5" – in four rich finishes and white
- Fast, easy installation – screw into suspension system or install with backer clip
- Create continuous looks and clouds with solid wood trim
- Complete standard system from one manufacturer
- BioAcoustic™ infill available for increased acoustical performance
- Acoustical fleece available as an option

FINISH SELECTION

Due to printing limitations, shade may vary from actual product.



Grille White (GWH)

Grille Maple (GMP)

Grille Light Cherry (GLC)

Grille Dark Cherry (GDC)

Grille Walnut (GWN)

Custom Finishes Available

WOODWORKS® Linear

Solid Wood Panels

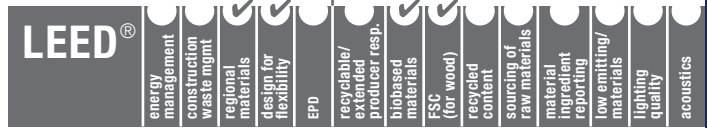

LOCATION DEPENDENT

VISUAL SELECTION

PERFORMANCE

Edge Profile	Item Number*	Description	Dimensions Nominal W x L x H (Inches) Custom Sizes Available	Acoustics*	Fire Rating
	6693W1 ___	Nominal 3" wide planks	12 x 96 x 3/4"	0.60	See below
	6694W1 ___	Nominal 5" wide planks	12 x 96 x 3/4"	0.50	See below

* When specifying or ordering, include the 3-letter color suffix that coordinates with your WoodWorks ceiling: (e.g., 6693W1 **GM P**)
 * NRC achieved with acoustical infill (Item 82001007).
 NOTE: For additional color and size options, or acoustical felt available as a custom option, call TechLine at 1 877 ARMSTRONG.

ACCESSORIES

Item Number	Description	Dimensions (Inches) Nominal W x L x H	Color	Pieces/Carton
7146 ___ *	Solid Wood Trim	4 x 120 x 3/4"	See Finishes Below	Bulk
5687†	Backer Clip	3/8 x 11/16 x 7/8"	N/A	250 pcs/pail
5671 ___ *	Ledger	1 x 96 x 1/4"	See Finishes Below	Bulk
7891	12 Gauge Soft Hanger Wire	144" Length	N/A	140
6657	BioAcoustic™ Infill Panel	11 x 48 x 5/8"	Black (Matte)	10

* When specifying or ordering, include the three-letter color suffix that coordinates with your WoodWorks ceiling: (e.g., 5671 **GM P**).
 † Backer clip should only be used when installing panels with 3" wide nominal planks.

SUSPENSION SYSTEMS

15/16"



Wood is a natural product and will exhibit natural variations in color, grain, and texture, and knot holes of up to 1/2" in diameter.



ACCESSORIES

Accessories, trim, and infill panels are available. See pages 135-136 in this catalog or visit armstrongceilings.com/woodworks

PHYSICAL DATA

Material
Planks and Backers – solid Poplar (yellow or hybrid)

Surface Finish
Clear or tinted semigloss coating on all finishes except Grille White (GWH). Grille White (GWH) has a lacquer finish.

Fire Performance
Solid Hardwood Planks and Backers – Class C ASTM E84 surface burning characteristics. Flame Spread Index 200 or less. Smoke Developed Index 450 or less.

Class A intumescent treatment is available for all finishes except Grille White (GWH).
 Fire performance will vary between wood species.
 Contact TechLine at 1 877 ARMSTRONG for details.

Woodworks Linear Solid Wood Panels, as with other architectural features located at the ceiling, may obstruct or skew the planned fire sprinkler water distribution pattern, or possibly delay or accelerate the activation of the sprinkler or fire detection systems by channeling heat from a fire either toward or away from the device. Designers and installers are advised to consult a fire protection engineer, NFPA 13, and local codes for guidance where automatic fire detection and suppression systems are present.

Application Considerations
Variation among panels may occur due to the natural characteristics of the wood and grain.

Design Considerations
It is very important that WoodWorks panels are climatized prior to installation. Relative humidity between 25% and 55%, and temperatures between 50°F and 86°F, must be maintained.

Installation Consideration

System is designed to have a 1" gap between panels. Backer clip can only be used for installations of the panel with 3" nominal planks (Item 6693).

Seismic Restraint

WoodWorks Linear Solid Wood Panels have been engineered, tested, and approved for application in all seismic areas when installed per Armstrong installation instructions.

Warranty

Details at armstrongceilings.com/warranty

Weight

6693 – 1.25 lbs/SF
 6694 – 1.25 lbs/SF
 (Bulk packaged)

WOODWORKS® Linear

Veneered Panels

CAD/Revit® drawings at:
armstrongceilings.com/details

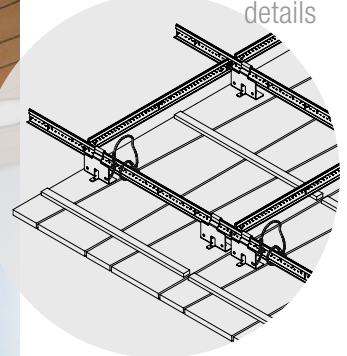
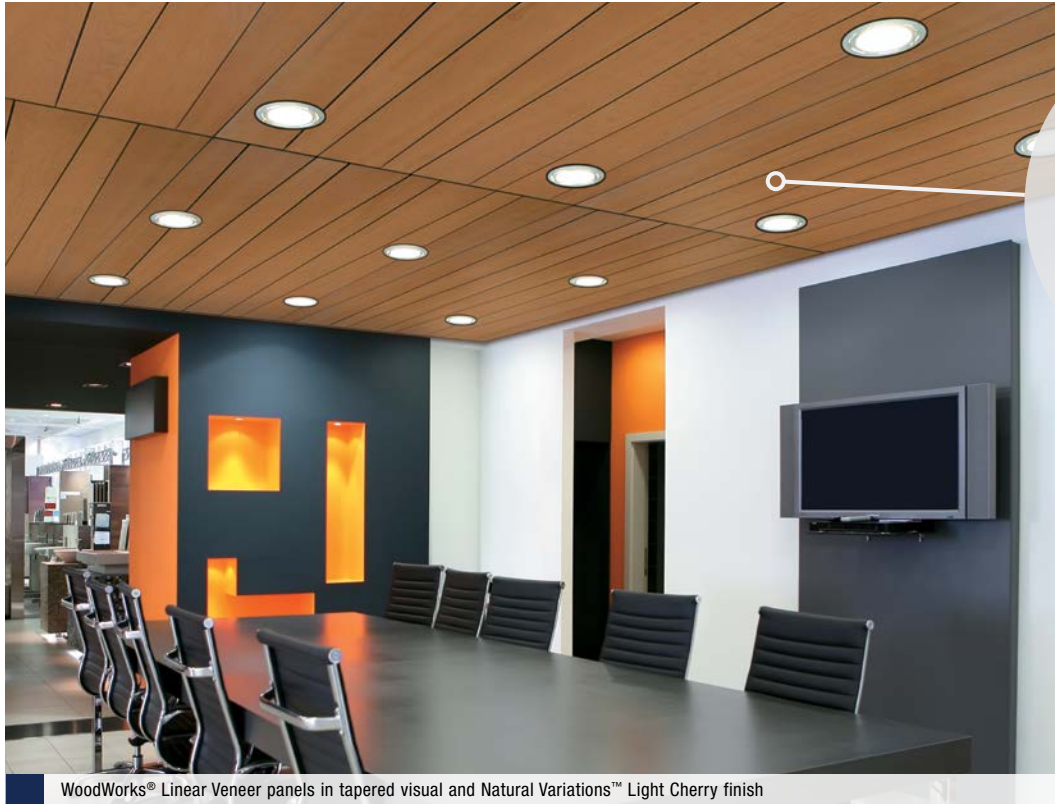

See more photos at:
armstrongceilings.com/photogallery
 SEARCH: woodworks linear

WoodWorks® Linear Veneer panels in tapered visual and Natural Variations™ Light Cherry finish

These unique tapered or traditional wood panels offer a variety of linear looks.

ADDITIONAL ATTRIBUTES

Veneered Panels

- Panels in nominal 4" or 6" widths
- Create continuous looks and clouds with veneer-wrapped and painted aluminum trim
- Patented hook-on panels (for standard 15/16" suspension system) provide safe and secure downward accessibility
- Complete standard system from one manufacturer (suspension system/panels/trim)
- Factory-edge banded for superior quality
- 100% Biobased content
- BioAcoustic™ infill available for increased acoustical performance
- Acoustical fleece available as an option

VENEERS Due to printing limitations, shade may vary from actual product.

Natural Variations™ (Real Wood Veneers)



Constants™ (Real Wood Veneers)



Bamboo**

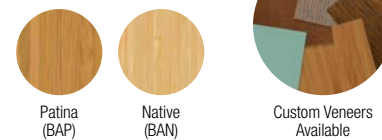

** Veneer is rapidly renewable. Bamboo is a grass that only requires 3-7 years for maturity and does not have to be replanted after each harvest.

WOODWORKS® Linear Veneered Panels



USDA
CERTIFIED
BIOBASED
PRODUCT
PRODUCT 100%



92% RECYCLED CONTENT

LEED®

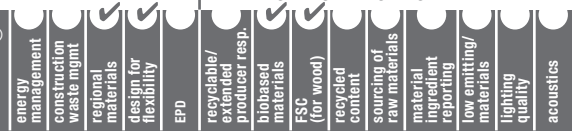

Calculate LEED contribution at armstrongceilings.com/greengenie

LOCATION DEPENDENT

VISUAL SELECTION

Edge Profile	Item Number*	Description	Dimensions Nominal W x L x H (Inches) Custom Sizes Available
FSC® certified WOODWORKS® Linear Veneered Panels			
3/4" Reveal	6690W1 _ _ _	Nominal 4" wide planks	24 x 96 x 3/4"
1/4" Reveal	6691W1 _ _ _	Nominal 6" wide planks	24 x 96 x 3/4"
1/4" Reveal	6692W1 _ _ _	Tapered planks	24 x 96 x 3/4"

* When specifying or ordering, include the appropriate 3-letter color suffixes.
 ** NRC achieved with BioAcoustic™ infill (item 6657).
 NOTE: Veneers and sizes available as special order; call TechLine at 1 877 ARMSTRONG.
 U.S. Patent number: 8,576,009

PERFORMANCE

Acoustics NRC**	Fire Rating
0.45	Class A
0.20	Class A
0.20	Class A

EXAMPLE: **6690W1 NLC**
 Panel Dimension/Type: 2' x 8' Nominal 4" wide planks
 Finish: Natural Variations™ Light Cherry

ACCESSORIES

Item Number	Description	Dimensions Nominal (Inches)	Color	Pieces/ Carton
6603W1 _ _ _*	WoodWorks Concealed Trim**	6 x 120"	Standard Veneers (see below) and Black (BL)	6
8200100	Fiberglass Infill Panel	24 x 24 x 1"	Black	12
5479	BioAcoustic™ Infill Panel	24 x 24 x 5/8"	Beige	12
5823	BioAcoustic Infill Panel	24 x 24 x 5/8"	Black (Matte)	12
6408 _ _ _*	Edge Banding	300 x 3/4"	Standard Veneers (see page 129)	1

* When specifying or ordering, include the 3-letter color suffix that coordinates with your WoodWorks ceiling (e.g., 6408 **N M P**)
 ** Trim cartons include FXTBC Clips and FX4SPICE Splice Plates.

SUSPENSION SYSTEMS

When ordering suspension system materials, please note that this product requires Prelude 15/16" Heavy-duty (HD) main beams and 2" cross tees that are full height (1-11/16"). Both suspension system components should be specified in Tech Black (BL).

Item Number	Description	Dimensions (Inches)	Pieces/Carton
5986	T-Bar Hook†	Nominal 4 x 2 x 3"	50
7123	Wood Screws	5/8"	300
6091	Safety Cable	24 x 3/32"	50
SH12	Support Hanger	144 x 2"	12

† For 24" x 96" panel, install eight hooks. NOTE: three screws per hook.
 NOTE: Refer to installation instructions at armstrong.com/installation for a better understanding of suspension system requirements.

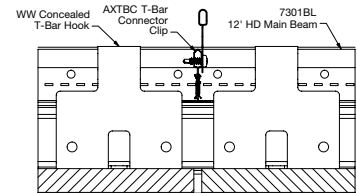

Installation Detail

PHYSICAL DATA

Material
 FSC certified fire-retardant particle board with face-cut veneers (SW-COC-003601). For more information about FSC certified products, or to view our FSC certification letter, visit armstrong.com/woodworksfscc

Surface Finish
 Clear or tinted semigloss coating

Fire Performance
 ASTM E84 surface burning characteristics. Flame Spread Index 25 or less. Smoke Developed Index 50 or less.
 CAN/ULC S102 surface burning characteristics. Flame Spread Rating 25 or less. Smoke Developed Classification 50 or less.

ASTM E1264 Classification
 Composite – Fire Class A

Application Considerations
 Variation among panels may occur due to the natural characteristics of the wood and grain.

Use of large wood panels may result in deflection up to 1/8" and cause alignment inconsistency due to size and ambient conditions.

It is very important that WoodWorks panels are climatized prior to installation. Relative humidity between 25% and 55%, and temperatures between 50°F and 86°F, must be maintained throughout the life of the product.

Design Considerations
 Cloud installations with total panel width less than 6' wide are not recommended.
 Cloud installations with total panel length less than 16' wide cannot be done.

Specification Consideration

Attention: For FSC certified wood products to maintain their CoC certification, products must be sold to a CoC certified distributor or directly to the installing contractor. Failure to do so breaks the CoC.

Seismic Restraint

WoodWorks Linear panels have been engineered, tested, and approved for application in all seismic areas when installed per Armstrong installation instructions.

Warranty

Details at armstrongceilings.com/warranty

Weight

6690, 6691, 6692 – 2.75 lbs/SF; bulk packaged per order. Suspension system, hardware, and accessories ordered separately.

TechLineSM / 1 877 ARMSTRONG
armstrongceilings.com/woodworks
 (search: woodworks linear veneered panels)
 BPCS-5126-715

LEED® is a registered trademark of the US Green Building Council
 Revit® is a registered trademark of Autodesk, Inc.
 FSC® is a registered trademark of FSC Forest Stewardship Council,
 A.C., license code FSC-C007626. All other trademarks used herein are the property of AWI Licensing Company and/or its affiliates
 © 2015 AWI Licensing Company Printed in the United States of America

Armstrong
 CEILING SOLUTIONS

130

WOODWORKS

WOODWORKS® Linear

Veneered Planks



CAD/Revit® drawings at:
armstrongceilings.com/details

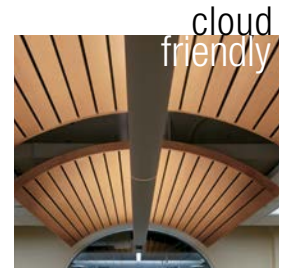
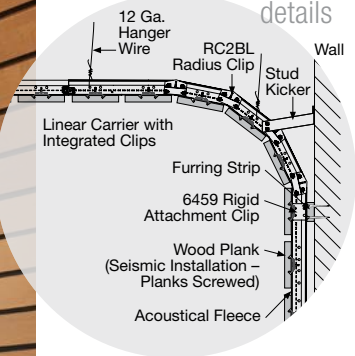

See more photos at:
armstrongceilings.com/photogallery
 SEARCH: woodworks linear

Standard, easy-to-install wood veneer planks offer a variety of installation options.

ADDITIONAL ATTRIBUTES

Lineared Planks

- Standard wood planks in two widths; nominal 4-1/2" and 6" modules, with traditional 3/4" reveals
- Standard factory-applied acoustic fleece
- Patented installation system allows for installation on the ceiling, wall, at 90° angle or in a curved ceiling-to-wall transitions (one-foot minimum radius)
- Create upturns for continuous visuals and clouds with veneer-wrapped WoodWorks Trim
- Suspension system and planks from one manufacturer; improved for 30-50% faster installation
- 100% Biobased content

VENEERS Due to printing limitations, shade may vary from actual product.

Natural Variations™ (Real Wood Veneers)



Constants™ (Real Wood Veneers)



Bamboo**

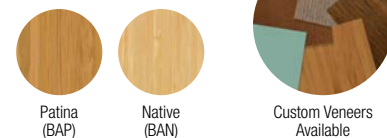

** Veneer is rapidly renewable. Bamboo is a grass that only requires 3-7 years for maturity and does not have to be replanted after each harvest.

WOODWORKS® Linear

Veneered Planks



USDA
CERTIFIED
BIOBASED
PRODUCT
PRODUCT 100%



The mark of
responsible forestry

92%

LEED®

- energy management
- construction waste mgmt
- regional materials
- design for flexibility
- EPD
- recyclable/extended producer resp.
- biobased materials
- FSC (for wood)
- recycled content
- sourcing of raw materials
- material ingredient reporting
- low emitting materials
- lighting quality
- acoustics

Calculate LEED contribution at
armstrongceilings.com/greengenie

VISUAL SELECTION

Edge Profile	Item Number*	Dimensions Nominal W x L x H (Inches)	Custom Sizes Available	PERFORMANCE	
				Acoustics** NRC	Fire Rating
WOODWORKS Linear – Nominal 4-1/2" Module					
	6440W1 _ _ _	96 x 3-3/4 x 3/4" with 3/4" reveal		0.50 0.60**	Class A
	6640W1 _ _ _ (FSC® certified)	96 x 3-3/4 x 3/4" with 3/4" reveal		0.50 0.60**	Class A
WOODWORKS Linear – Nominal 6" Module					
	6460W1 _ _ _	96 x 5-1/4 x 3/4" with 3/4" reveal		0.40 0.50**	Class A
	6660W1 _ _ _ (FSC certified)	96 x 5-1/4 x 3/4" with 3/4" reveal		0.40 0.50**	Class A

* When specifying or ordering, include the appropriate 3-letter color suffix (e.g., 6440W1 N M P)

** Adding acoustical infill (item 8200100, 5479, or 5823) for 4-1/2" module increases the NRC to 0.60. Adding acoustical fiberglass infill for 6" module increases the NRC to 0.45; adding BioAcoustic™ infill 5479 increases NRC to 0.50. For additional infill options, refer to the Acoustical Infill Panels catalog pages 135-136. U.S. Patent number: 8,857,121

ACCESSORIES For additional accessory items see pages 135-136.

Item Number	Description	Dimensions Nominal (Inches)	Pieces/Carton
5843	Linear Wood Panel Splice	—	100
5948	Linear and Channeled Trim Connector Clip	N/A	30
RC2BL	Radius Clip for faceted grid applications (Black)	—	205 pcs/bucket
6459BL	Rigid Attachment Clip (Black)	5-1/2 x 1-3/4"	25
92715A620	Self-tapping Screws (Black)	#2 x 3/4" Length	25

* When specifying or ordering, include the 3-letter color suffix that coordinates with your WoodWorks ceiling (6440W1 N M P.)

SUSPENSION SYSTEM

Item Number	Description	Dimensions (Inches)	Pieces/Carton
5370	12' HD Linear Carriers (concealed) with integral clips (factory-applied) for nominal 4-1/2" modules	144 x 15/16 x 1-11/16"	10 (Approx. 240 SF/ctn installed with planks)
5371	12' HD Linear Carriers (concealed) with integral clips (factory-applied) for nominal 6" modules	144 x 15/16 x 1-11/16"	10 (Approx. 240 SF/ctn installed with planks)

NOTE: For radiused applications, use standard panels and HD linear carriers faceted 12" on center with RC2BL clips.

PHYSICAL DATA

Material

Fire-retardant particle board with face-cut veneers. FSC certified fire-retardant particle board with face-cut veneers (SW-COC-003601). For more information about FSC certified products or to view our FSC certification letter, visit armstrongceilings.com/woodworksfscc. Factory-applied black fleece on each plank to cover the reveal.

Surface Finish

Clear or tinted semigloss coating

Fire Performance

ASTM E84 surface burning characteristics. Flame Spread Index 25 or less. Smoke Developed Index 50 or less.

CAN/ULC S102 surface burning characteristics. Flame Spread Rating 25 or less. Smoke Developed Classification 50 or less.

Linear wood, as with other architectural features located at the ceiling, may obstruct or skew the planned fire sprinkler water distribution pattern, or possibly delay or accelerate the activation of the sprinkler or fire detection systems by channeling heat from a fire either toward or away from the device. Designers and installers are advised to consult a fire protection engineer, NFPA 13, and local codes for guidance where automatic fire detection and suppression systems are present.

ASTM E1264 Classification

Composite – Fire Class A

Application Considerations

Variation among panels may occur due to the natural characteristics of the wood and grain. It is very important that WoodWorks planks are climatized prior to installation. Relative humidity between 25% and 55%, and temperatures between 50°F and 86°F, must be maintained.

Specification Consideration

Attention: For FSC certified wood products to maintain their CoC certification, products must be sold to a CoC certified distributor or directly to the installing contractor. Failure to do so breaks the CoC.

Installation Considerations

Installation can use staggered, random joints for a monolithic appearance or consistent lengths for a modular style. For expansion, a 3/4" gap is recommended at every 24-foot run of plank. See installation instructions BPLA-297443 at armstrongceilings.com/installation.

Seismic Restraint

WoodWorks Linear planks have been engineered, tested, and approved for application in all seismic areas when installed per Armstrong installation instructions.

Warranty

Warranty details at armstrongceilings.com/warranty

Weight

6440, 6640 – 2.88 lbs/SF
6460, 6660 – 2.89 lbs/SF
(Bulk packaged)

TechLine™ / 1 877 ARMSTRONG
armstrongceilings.com/woodworks
(search: woodworks linear veneered planks)
BPCS-5127-1115

LEED® is a registered trademark of the US Green Building Council
Revit® is a registered trademark of Autodesk, Inc.
FSC® is a registered trademark of FSC Forest Stewardship Council,
A.C., license code FSC-C007626. All other trademarks used herein are the property of AWI Licensing Company and/or its affiliates
© 2015 AWI Licensing Company Printed in the United States of America

Armstrong®
CEILING SOLUTIONS

132

WOODWORKS